



The Running Magnet Kit 5

Suspended by Wire Version Spot Modules JA8 Black

Description

Fun with magnets and light. Simultaneously graphic and subtle, the Running Magnet is flexible, precise, and as creative as you. It is track lighting redesigned and elegantly refined. Light elements snap in place and connect automatically through the magic of magnets. Extruded aluminum housings create a clean 1-3/8-inch slot and preconfigured corners complete the system that can run up, around and across walls and ceilings. Finishes align perfectly, always, because Running Magnet can be easily cut on site (except Suspension Up&Down). Linear LED and accent fixtures, available in a variety of sizes, can be exchanged and repositioned quickly, without tools, with artistic results. The Running Magnet is perfect for retail displays where frequent changes are typical and absolute performance is mandatory.

Dimensions

KIT_RM5

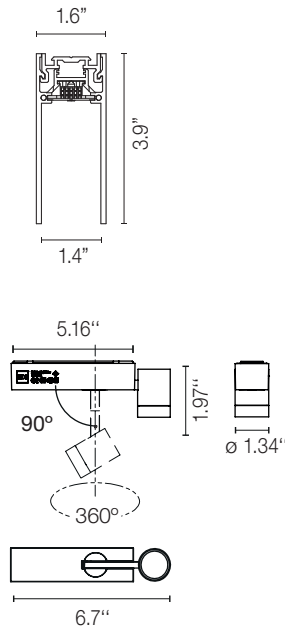

Lamp

System Lamp Type	LED
Color Temperature	2700K, *3000K, *3500K, *4000K (See Notes)
Color Rendering	CRI90
Application	Accent lighting

Physical

Material	Aluminum
Ingress Protection Rating	IP20
Finishes	■ 14 Black
Installation type	Ceiling Surface, Cable Suspended
Environment	Indoor

Certifications



JAB-2019 CA
TITLE 24
LISTED



Photometrics

For current IES files please visit
professional.flos.com/en-US/us

Warranty

2 years from date of sale.

Electrical & Control

Driver location	Remote
Driver Input Voltage	120V-277V
Driver Output Voltage	24V
Maximum Driver Wattage	Class 2 - 40W
Control	Standard 0-10V dimming (10-100%)



The Running Magnet Kit 5

Suspended by Wire Version Spot Modules JA8 Black

Notes

EC to supply site cabling from driver to track location and site UL listed enclosure.

All components required for the installation are included with the system with the exception of 0-10V control.

3000K, 3500K , 4000K and other CCT available but not cataloged. Consult factory for additional color temperatures.

Dimensions

KIT_RM5

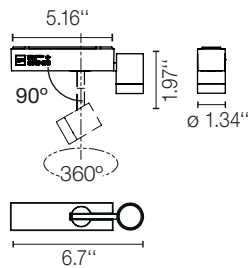

SECTION: Remotes

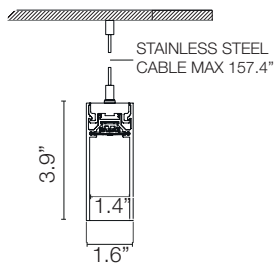

Certifications



JA8-2019 CA
TITLE 24
LISTED



Photometrics

For current IES files please visit
professional.flos.com/en-US/us

Warranty

2 years from date of sale.

The Running Magnet Kit 5
Suspended by Wire Version Spot Modules JA8 Black

How to specify

M J 0 0 5 U 2 4 0 0 0 0 1
Part Number

KIT_RM5: MJ005U2400001

Table with 8 columns: Unit, Finish, CCT, CRI, Delivered Lumens, Watts, Description. Row 1: Track 39.5 inches. Row 2: Spot Module.

PHOTOMETRICS

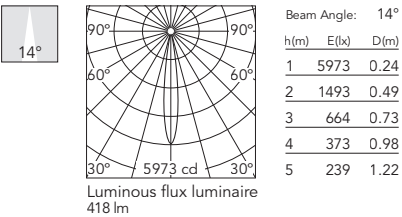

Spot Module Suspended Down Light - Cable

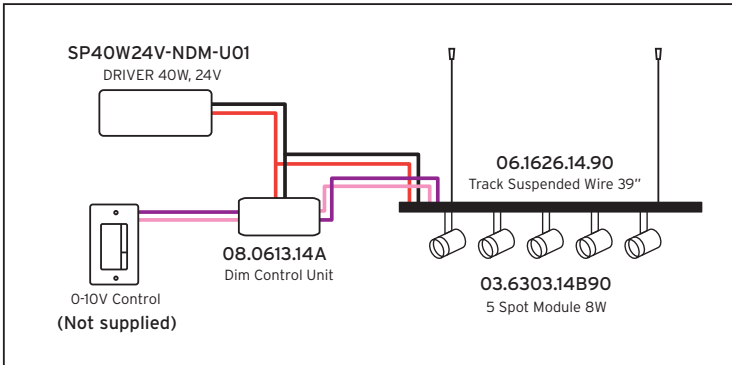

The Running Magnet Kit 5

Suspended by Wire Version Spot Modules JA8 Black

Included Accessories

Dimming Control Unit Box 24V 0-10V
Required for a 0-10V Dimming
installation. 1 DCU can control up to 25
fixtures

Part Number:

■ 08.0613.14A

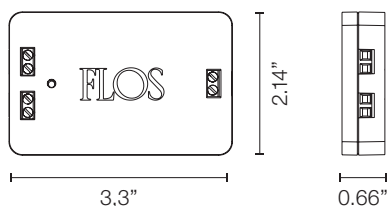

40W non dimmable, 120-277V input.
24V output. (0-10V dim is through Dim
Control Unit)

Part Number:

SP40W24V-NDM-U01

